

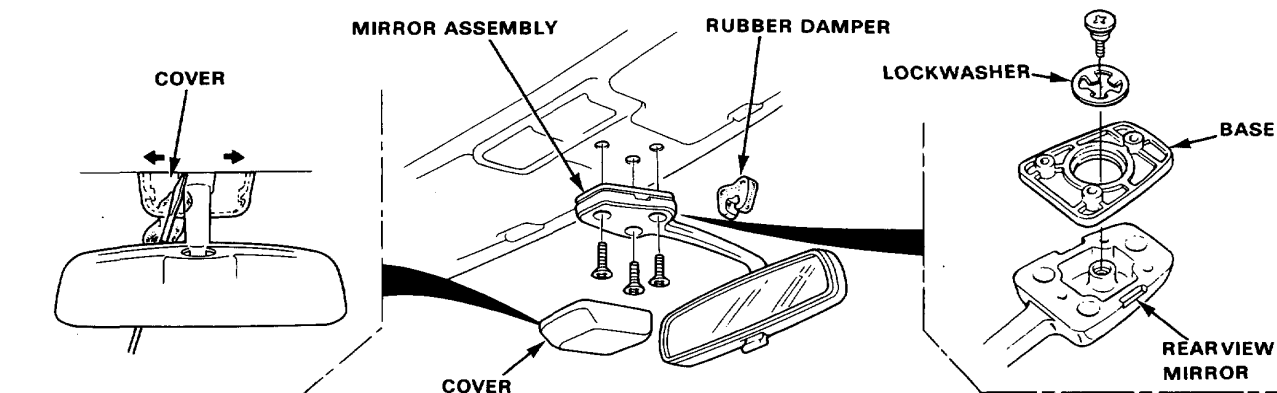

Rearview Mirror / Console

Rearview Mirror Replacement

1. Remove the rubber damper.
2. Pry the cover off using the end of a flat tip screwdriver.
3. Remove the 3 mounting screws from the mirror base, then remove the mirror assembly.
4. Remove the base from the bracket by removing the screw.



Console Replacement

Disassemble in numbered sequence.

4WS:

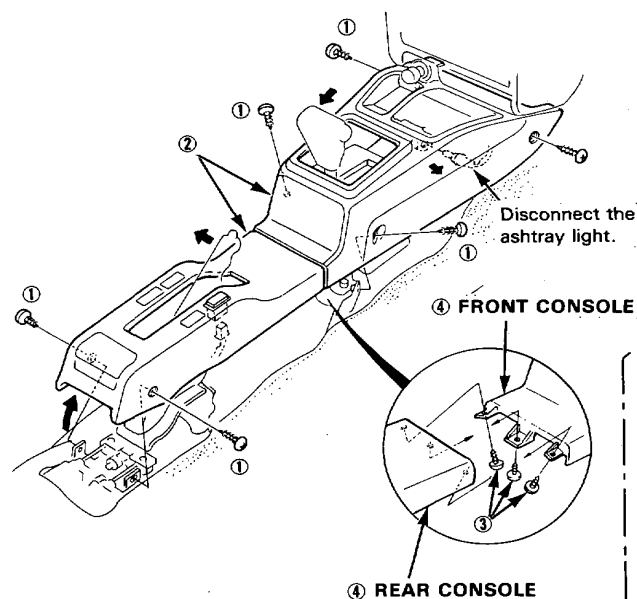

2WS:

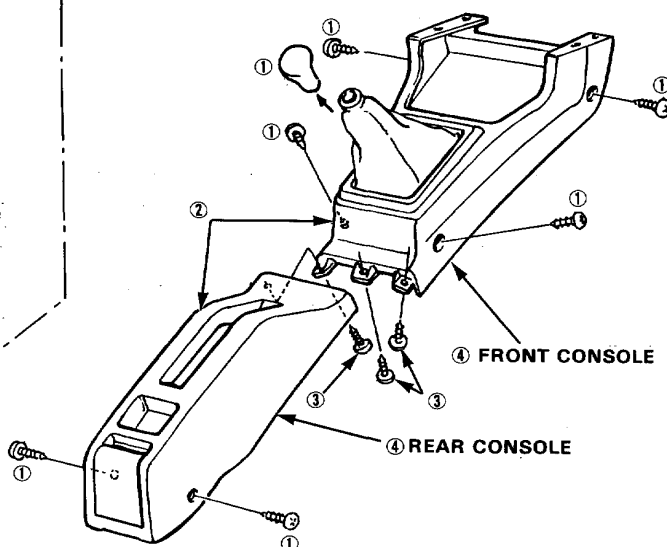

NOTE:

- Remove the front and rear consoles as an assembly.
- Lift up the parking brake lever.
- For manual transmission models, remove the shift lever knob.